

FRONTAL VIEW

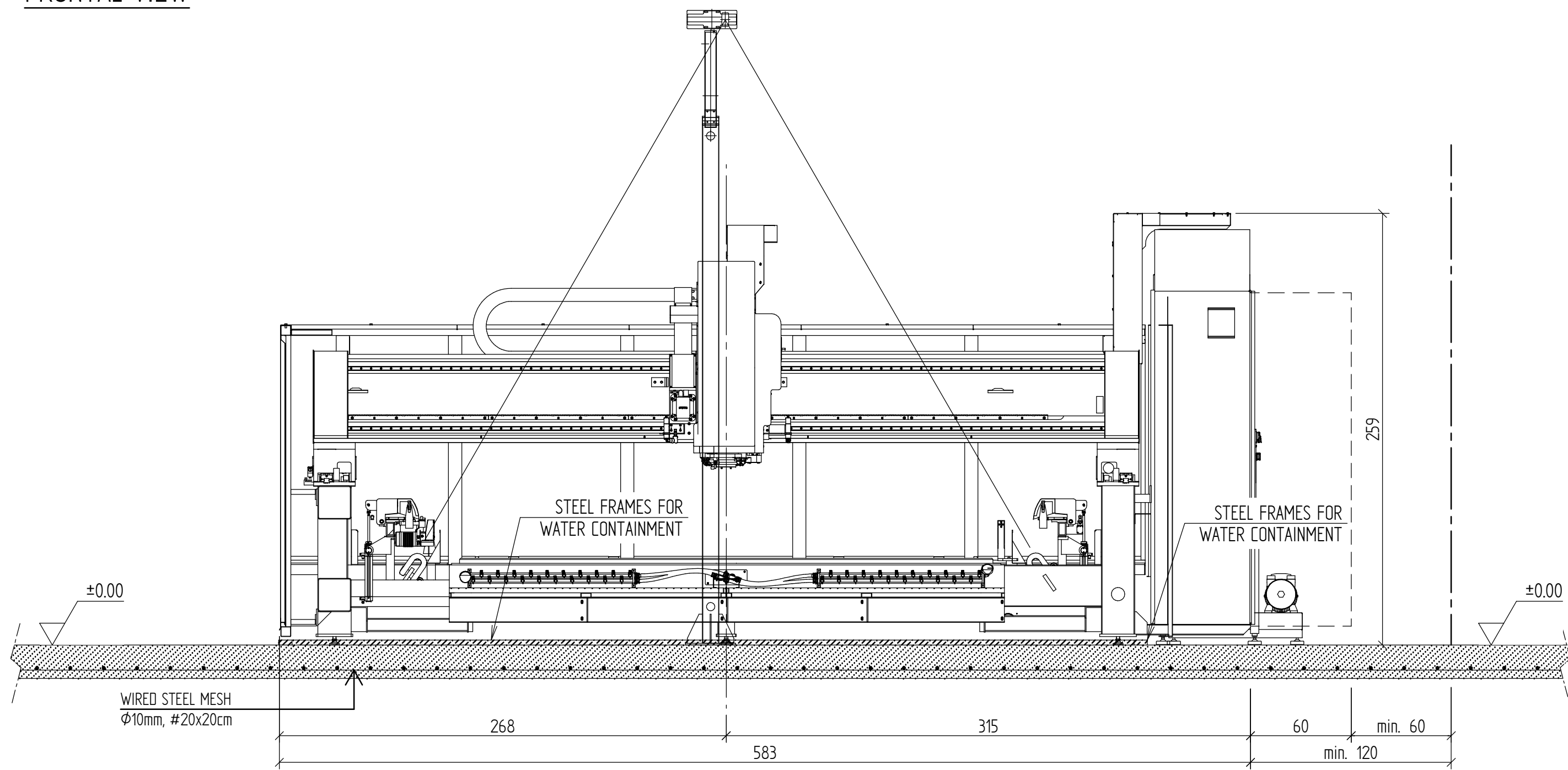

DRAFT

PLAN VIEW

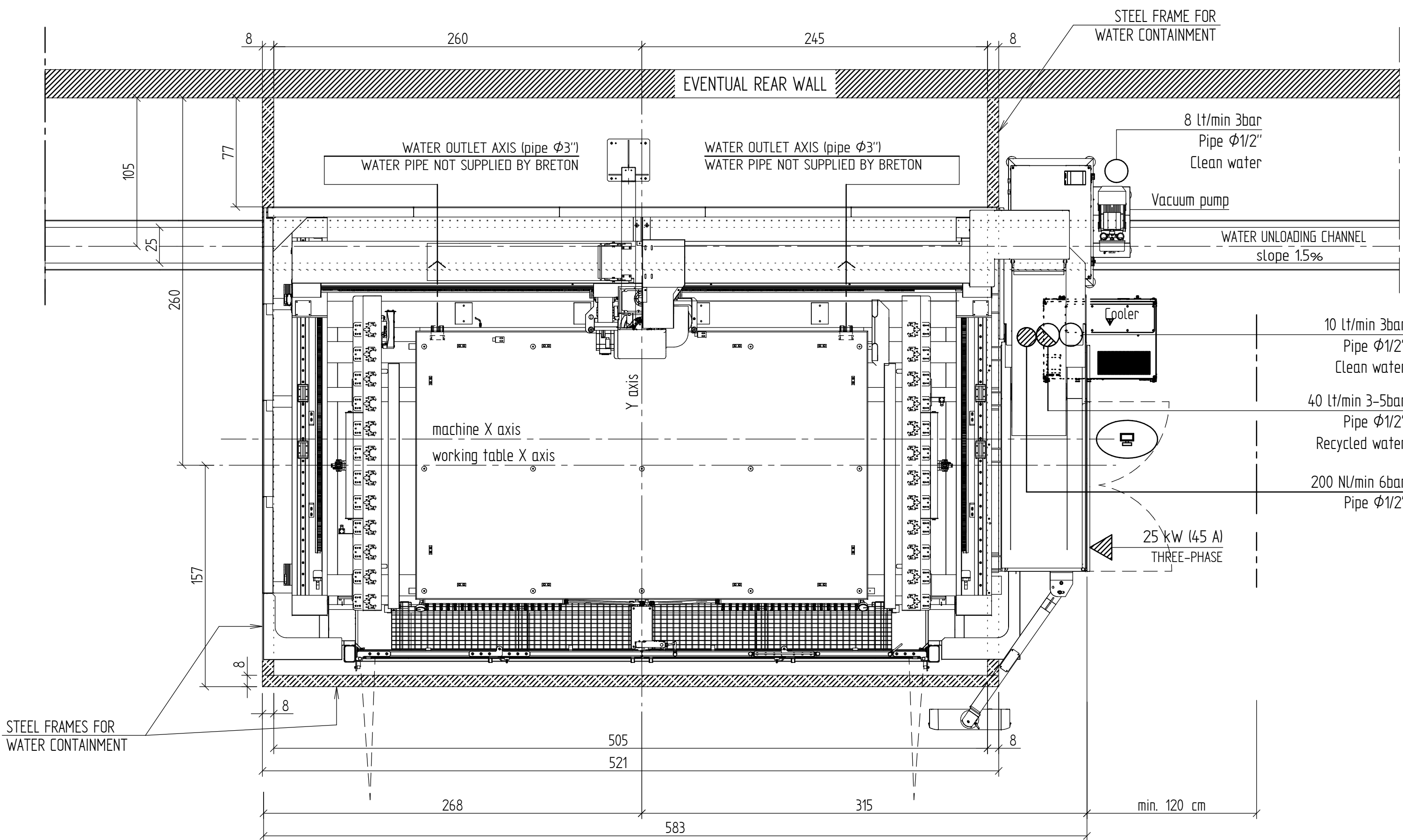

SIDE VIEW

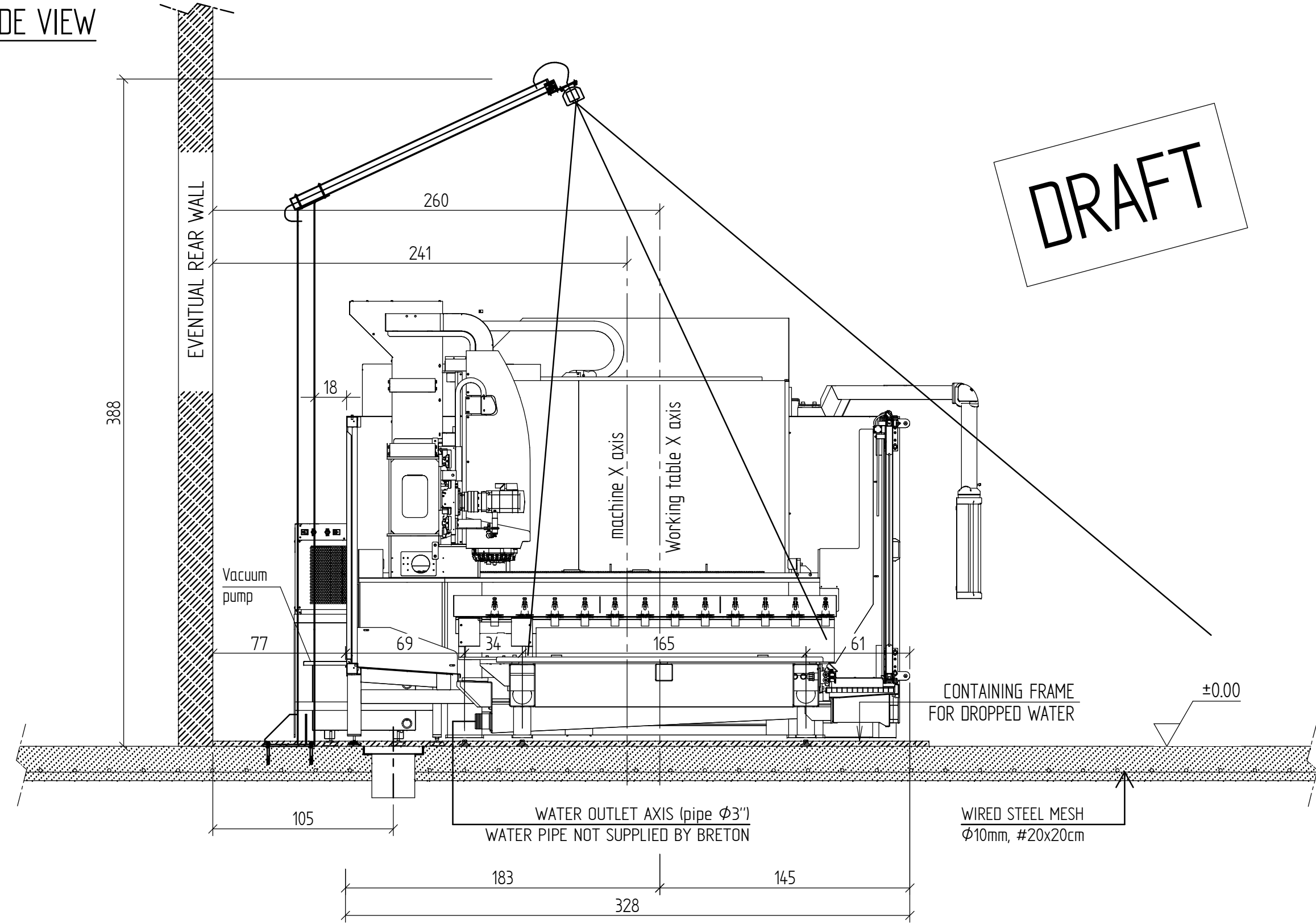

DRAFT

OPERATING VOLTAGE	400V - 50Hz		FEEDING POINT ON DISTRIBUTION BOARD
			POWER CONTROL BOARD
OPERATING PRESSURE	: min.3-max.5 bar		RECYCLED WATER SUPPLY
Ø PIPE CONNECTION TO THE MACHINE: INCH			FILTERED AT 250 micron; SOLID CONCENTRATION max 80 mg/L;
OPERATING PRESSURE	: min.3-max.5 bar		CLEAN WATER SUPPLY OR
Ø PIPE CONNECTION TO THE MACHINE: INCH			RECYCLED WATER FILTERED AT 25 micron; SOLID CONCENTRATION max 20 mg/L;
OPERATING PRESSURE	: 6 bar		COMPRESSED AIR SUPPLY
Ø PIPE CONNECTION TO THE MACHINE: INCH			(DRIED, OILFREE, FILTERED AT 5 micron)
			NETWORK CONNECTION (REMOTE INTERNET)
N.B. ALL THE ELECTRICAL CONTROL BOARD MUST BE EARTHED BY MEANS OF AN ADEQUATE GROUND CABLE			

COMMON CHARACTERISTICS FOR CLEAN AND RECYCLED WATER	
AGGRESSIVE INDEX (AI)	11÷12
ELECTRICAL CONDUCTIVITY	max 600 µS/cm
CHLORIDES CONCENTRATION	max 150 mg/L
NOTICE: USE WATER THAT IS FREE FROM CORROSION-INDUCING CHEMICAL ELEMENTS.	

GROUND PRESCRIPTIONS
GROUND ALLOWABLE PRESSURE > 1,0 daN/cm²
ABSENCE OF SOIL ENBANKMENT UNDER THE FOUNDATION

MATERIALS PRESCRIPTIONS
CONCRETE FLOOR: CONCRETE class min. C20/25 (Rck=250 daN/cm²)
Min. thickness 20cm
WIRED STEEL MESH Ø10mm, #20x20cm

REMARKS
STELL PROFILE 80x30mm, FOR DROPPING WATER CONTAINMENT, IS NOT INCLUDED IN BRETON SUPPLY.
THE FRAME MUST BE FIXED TO THE FLOOR USING EXPANSION BOLTS (ABOUT ONE EVERY 40cm) NOT INCLUDED IN BRETON SUPPLY.
THE FRAME MUST BE SEALED TO THE FLOOR BY MEAN OF SILICONE.
THE RUBBER HOSES, NEEDED TO DRAIN WATER FROM THE MACHINES TO THE WATER DRAINING CHANNEL, ARE NOT INCLUDED IN BRETON SUPPLY.

ALL DIMENSIONS ARE IN cm EXCEPT WHEN OTHERWISE INDICATED

REVISION	DESCRIZIONE MODIFICA MODIFIED DESCRIPTION	DATA DATE	DISEGNATO DRAWN	CONTROLLATO CONTROLLED	APPROVATO APPROVED
CLIENTE : CUSTOMER					
DENOMINAZIONE/DESCRIPTION: CONTOURBRETON "FORTE COMPACT"					
N° DISEGNO/N° DRAWING: F1766-L					
REV:					
SCALA/SCALE: 1:25					
UM: cm					
FOGLIO/SHEET: 1 / 1					
TAVOLA: FORMAT: A1					
STATO DOCUMENTO: DRAFT					